

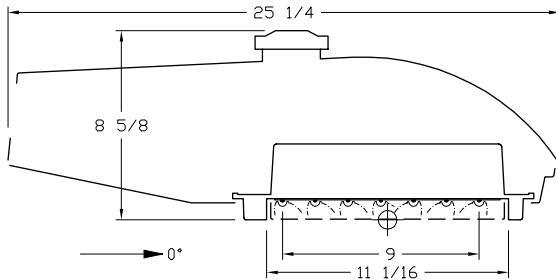

**ISOFOOTCANDLE LINES OF HORIZONTAL ILLUMINATION**  
Values based on 25 foot mounting height.

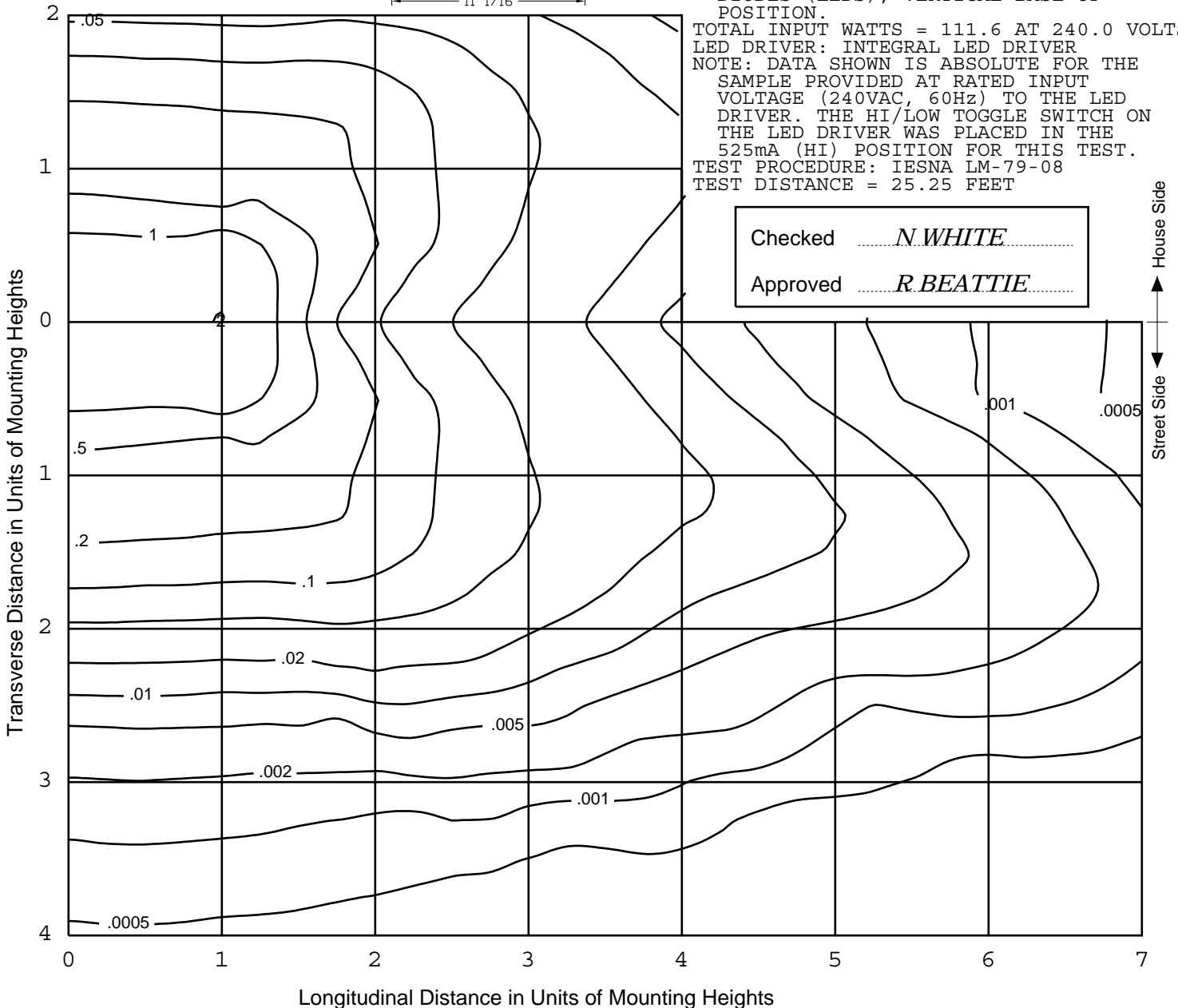

REPORT NUMBER: ITL63834  
DATE: 12/14/09  
PREPARED FOR: ECOFIT LIGHTING  
CATALOG NUMBER: DURASTREET 63 SERIES,  
525mA - TYPE 5 SQUARE  
LUMINAIRE: CAST METAL HOUSING. ONE LED  
MODULE CONSISTING OF: CAST FINNED  
METAL HEAT SINK AND LED DRIVER  
HOUSING, ONE WHITE CIRCUIT BOARD WITH  
SEVEN ROWS OF NINE LEDS, ONE CLEAR  
PLASTIC LENS BELOW EACH LED, SEVEN  
MOLDED BLACK PLASTIC REFLECTORS WITH  
SPECULAR FINISH AND BLACK SECTION AT  
EACH END, CLEAR PLASTIC LENS. CAST  
GRAY PAINTED METAL DOOR FRAME. LED  
MODULE NOT DISASSEMBLED FOR  
INSPECTION.  
LAMP: SIXTY-THREE WHITE LIGHT EMITTING  
DIODES (LEDS), VERTICAL BASE-UP  
POSITION.  
TOTAL INPUT WATTS = 111.6 AT 240.0 VOLTS  
LED DRIVER: INTEGRAL LED DRIVER  
NOTE: DATA SHOWN IS ABSOLUTE FOR THE  
SAMPLE PROVIDED AT RATED INPUT  
VOLTAGE (240VAC, 60Hz) TO THE LED  
DRIVER. THE HI/LOW TOGGLE SWITCH ON  
THE LED DRIVER WAS PLACED IN THE  
525mA (HI) POSITION FOR THIS TEST.  
TEST PROCEDURE: IESNA LM-79-08  
TEST DISTANCE = 25.25 FEET





REPORT NUMBER: ITL63834  
 DATE: 12/14/09  
 PREPARED FOR: ECOFIT LIGHTING  
 CATALOG NUMBER: DURASTREET 63 SERIES,  
 525mA - TYPE 5 SQUARE  
 LUMINAIRE: CAST METAL HOUSING. ONE LED  
 MODULE CONSISTING OF: CAST FINNED  
 METAL HEAT SINK AND LED DRIVER  
 HOUSING, ONE WHITE CIRCUIT BOARD WITH  
 SEVEN ROWS OF NINE LEDS, ONE CLEAR  
 PLASTIC LENS BELOW EACH LED, SEVEN  
 MOLDED BLACK PLASTIC REFLECTORS WITH  
 SPECULAR FINISH AND BLACK SECTION AT  
 EACH END, CLEAR PLASTIC LENS. CAST  
 GRAY PAINTED METAL DOOR FRAME. LED  
 MODULE NOT DISASSEMBLED FOR  
 INSPECTION.  
 LAMP: SIXTY-THREE WHITE LIGHT EMITTING  
 DIODES (LEDS), VERTICAL BASE-UP  
 POSITION.  
 TOTAL INPUT WATTS = 111.6 AT 240.0  
 VOLTS  
 LED DRIVER: INTEGRAL LED DRIVER  
 NOTE: DATA SHOWN IS ABSOLUTE FOR THE  
 SAMPLE PROVIDED AT RATED INPUT  
 VOLTAGE (240VAC, 60Hz) TO THE LED  
 DRIVER. THE HI/LOW TOGGLE SWITCH ON  
 THE LED DRIVER WAS PLACED IN THE  
 525mA (HI) POSITION FOR THIS TEST.  
 TEST PROCEDURE: IESNA LM-79-08  
 TEST DISTANCE = 25.25 FEET

MAXIMUM PLANE AND MAXIMUM CONE PLOTS OF CANDELA

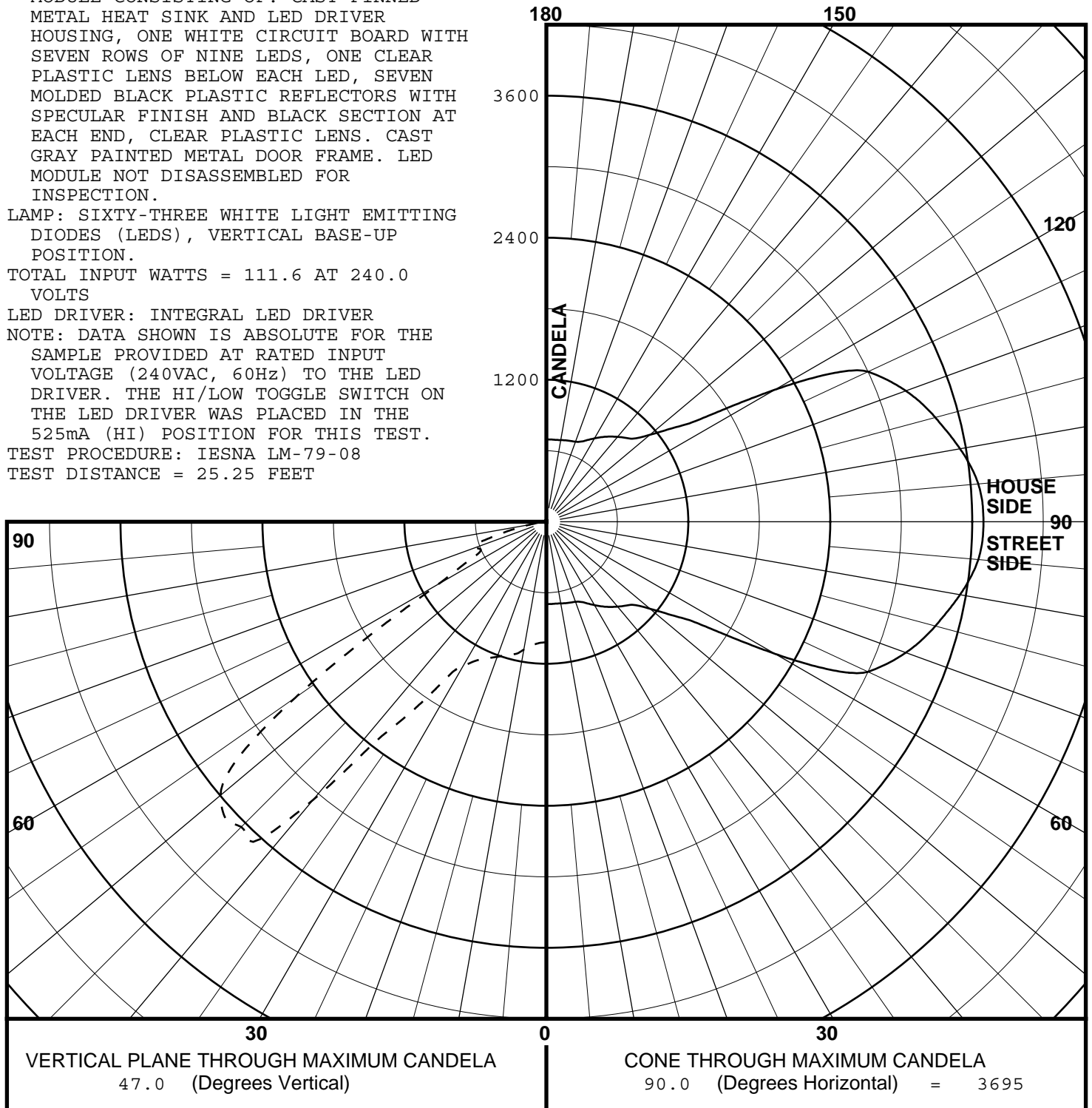



REPORT NUMBER: ITL63834  
 DATE: 12/14/09  
 PREPARED FOR: ECOFIT LIGHTING

COEFFICIENTS OF UTILIZATION AND FLUX DISTRIBUTION

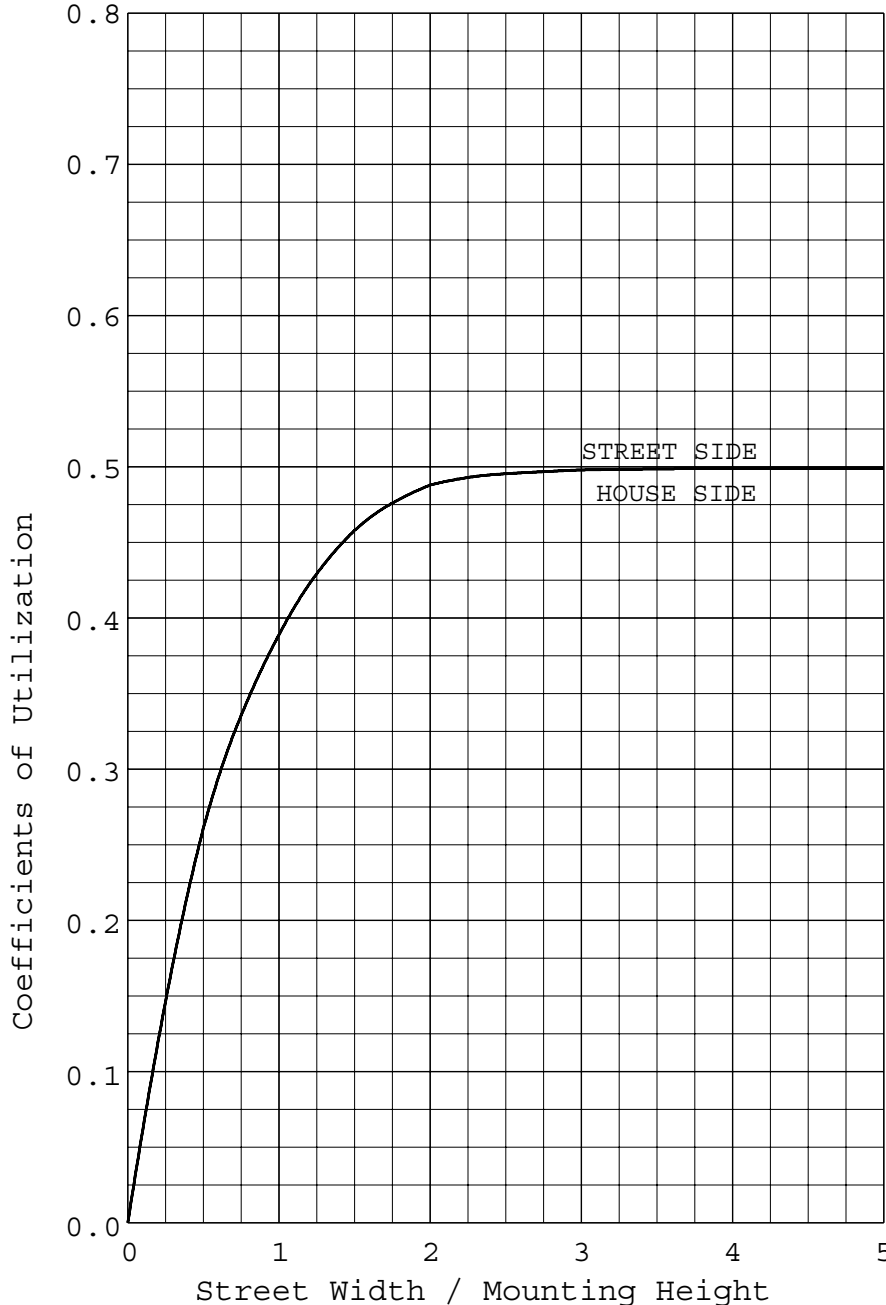

	LUMENS	PERCENT OF FIXTURE
DOWNWARD STREET SIDE	2875.	50.0
DOWNWARD HOUSE SIDE	2875.	50.0
DOWNWARD TOTAL	5750.	100.0
UPWARD STREET SIDE	0.	0.0
UPWARD HOUSE SIDE	0.	0.0
UPWARD TOTAL	0.	0.0
TOTAL FLUX	5750.	100.0
EFFICACY = 51.5 Lm/W		

ALL CANDELA AND LUMENS IN THIS REPORT ARE BASED ON ABSOLUTE PHOTOMETRY. THE COEFFICIENT OF UTILIZATION VALUES ARE BASED ON THE TOTAL ABSOLUTE LUMEN OUTPUT OF THIS LUMINAIRE SAMPLE.



**itl boulder**  
THE LIGHT CENTER OF THE INDUSTRY SINCE 1955

INDEPENDENT TESTING LABORATORIES, INC.  
3386 LONGHORN ROAD, BOULDER, CO 80302 USA

PHONE: (303)442-1255 • FAX: (303)449-5274 • E-MAIL: [itl@itlboulder.com](mailto:itl@itlboulder.com) • WEBSITE: [www.itlboulder.com](http://www.itlboulder.com)

REPORT NUMBER: ITL63834  
DATE: 12/14/09  
PREPARED FOR: ECOFIT LIGHTING

FLUX DISTRIBUTION BY SOLID ANGLE  
(PER IESNA TM-15-07, LUMINAIRE CLASSIFICATION  
SYSTEM FOR OUTDOOR LUMINAIRES)

	LUMENS	PERCENT OF FIXTURE
FORWARD LIGHT	2875.	50.0
FL ( 0- 30)		8.2
FM ( 30- 60)		29.9
FH ( 60- 80)		11.6
FVH( 80- 90)		0.3
BACK LIGHT	2875.	50.0
BL ( 0- 30)		8.2
BM ( 30- 60)		29.9
BH ( 60- 80)		11.6
BVH( 80- 90)		0.3
UPLIGHT	0.	0.0
UL ( 90-100)		0.0
UH (100-180)		0.0
TRAPPED LIGHT	0.	0.0
TOTAL FLUX	5750.	100.0



**itl boulder**  
THE LIGHT CENTER OF THE INDUSTRY SINCE 1955

INDEPENDENT TESTING LABORATORIES, INC.  
 3386 LONGHORN ROAD, BOULDER, CO 80302 USA

PHONE: (303)442-1255 • FAX: (303)449-5274 • E-MAIL: itl@itlboulder.com • WEBSITE: www.itlboulder.com

REPORT NUMBER: ITL63834  
 PREPARED FOR: ECOFIT LIGHTING

DATE: 12/14/09

CANDELA TABULATION

	LATERAL ANGLE										
	0.0	5.0	15.0	25.0	35.0	45.0	55.0	65.0	75.0	85.0	90.0
	90.0	0.	0.	0.	0.	0.	0.	0.	0.	0.	0.
	87.5	0.	0.	0.	1.	2.	3.	4.	5.	12.	6.
	85.0	2.	3.	3.	4.	5.	8.	10.	17.	49.	25.
	82.5	5.	6.	6.	7.	10.	14.	21.	41.	252.	66.
	80.0	9.	10.	11.	13.	17.	24.	39.	140.	928.	156.
	77.5	15.	16.	17.	21.	26.	40.	150.	514.	1195.	389.
	75.0	22.	23.	25.	30.	39.	144.	523.	1065.	1159.	622.
	72.5	30.	32.	36.	45.	92.	450.	1073.	1431.	1059.	769.
	70.0	48.	50.	63.	101.	223.	779.	1490.	1413.	1070.	735.
	67.5	104.	109.	139.	209.	404.	1116.	1805.	1370.	1268.	693.
	65.0	203.	208.	251.	361.	666.	1234.	1790.	1473.	1532.	725.
	62.5	335.	342.	409.	579.	818.	1293.	1678.	1574.	1847.	899.
	60.0	506.	511.	563.	692.	915.	1233.	1603.	1781.	2220.	1177.
	57.5	607.	612.	652.	775.	1006.	1125.	1527.	1974.	2832.	1818.
V	55.0	676.	682.	725.	827.	973.	1057.	1427.	2496.	3258.	2666.
E	52.5	723.	725.	746.	808.	934.	1043.	1366.	2999.	3426.	3326.
R	50.0	710.	712.	728.	783.	906.	1018.	1317.	3214.	3434.	3580.
T	47.5	695.	698.	714.	762.	883.	980.	1413.	3026.	3414.	3660.
I	47.0<<	696.	696.	710.	753.	877.	995.	1429.	3000.	3404.	3665.
C	45.0	688.	690.	704.	744.	841.	982.	1560.	2876.	3258.	3607.
A	42.5	678.	679.	697.	742.	821.	963.	1684.	2339.	3118.	3620.
L	40.0	678.	682.	699.	736.	812.	1085.	1681.	1914.	2445.	2996.
	37.5	681.	683.	699.	737.	831.	1263.	1509.	1726.	1957.	2238.
A	35.0	686.	689.	706.	755.	1017.	1308.	1408.	1457.	1718.	1892.
N	32.5	705.	713.	757.	934.	1167.	1278.	1312.	1353.	1465.	1542.
G	30.0	882.	893.	976.	1097.	1178.	1230.	1237.	1287.	1367.	1409.
L	27.5	1047.	1053.	1078.	1119.	1163.	1178.	1184.	1244.	1300.	1328.
E	25.0	1071.	1073.	1087.	1105.	1125.	1127.	1157.	1212.	1253.	1277.
	22.5	1058.	1062.	1069.	1074.	1081.	1099.	1141.	1189.	1224.	1243.
	20.0	1035.	1037.	1036.	1035.	1047.	1086.	1127.	1164.	1196.	1212.
	17.5	1002.	1003.	1005.	1015.	1039.	1079.	1118.	1145.	1167.	1182.
	15.0	996.	997.	1006.	1018.	1037.	1070.	1105.	1131.	1150.	1160.
	12.5	1007.	1007.	1013.	1024.	1038.	1055.	1084.	1111.	1129.	1138.
	10.0	1012.	1013.	1018.	1025.	1034.	1043.	1056.	1075.	1088.	1096.
	7.5	1014.	1015.	1018.	1021.	1027.	1034.	1042.	1049.	1054.	1057.
	5.0	1014.	1014.	1016.	1018.	1022.	1026.	1029.	1033.	1037.	1038.
	2.5	1016.	1017.	1016.	1017.	1017.	1018.	1020.	1021.	1023.	1025.
	0.0	1018.	1018.	1018.	1018.	1018.	1018.	1018.	1018.	1018.	1018.

PLANE OF MAXIMUM CANDELA

CONE OF MAXIMUM CANDELA