



**itl boulder**  
 THE LIGHT CENTER OF THE INDUSTRY SINCE 1955

INDEPENDENT TESTING LABORATORIES, INC.  
 3386 LONGHORN ROAD, BOULDER, CO 80302 USA

PHONE: (303)442-1255 • FAX: (303)449-5274 • E-MAIL: itl@itlboulder.com • WEBSITE: www.itlboulder.com

**ISOFOOTCANDLE LINES OF HORIZONTAL ILLUMINATION**  
 Values based on 25 foot mounting height.

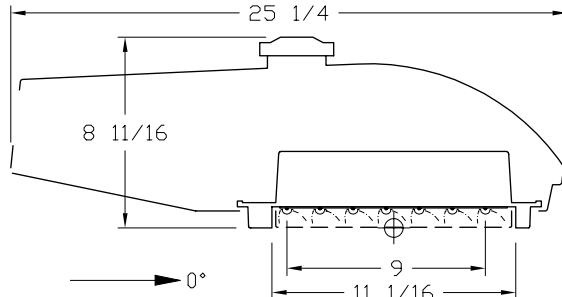

REPORT NUMBER: ITL65042  
 DATE: 06/08/10  
 PREPARED FOR: ECOFIT LIGHTING  
 CATALOG NUMBER: DURASTREET 42 SERIES,  
 350mA, TYPE 2/3  
 LUMINAIRE: CAST METAL HOUSING. ONE LED  
 MODULE CONSISTING OF: CAST FINNED  
 METAL HEAT SINK AND LED DRIVER  
 HOUSING, ONE WHITE CIRCUIT BOARD WITH  
 SEVEN ROWS OF SIX LEDS, ONE CLEAR  
 PLASTIC LENS BELOW EACH LED, SEVEN  
 MOLDED BLACK PLASTIC REFLECTORS WITH  
 SPECULAR FINISH, CLEAR PLASTIC LENS.  
 CAST GRAY PAINTED METAL DOOR FRAME.  
 LED MODULE NOT DISASSEMBLED FOR  
 INSPECTION.  
 LAMPS: FORTY-TWO WHITE LIGHT EMITTING  
 DIODES (LEDS), VERTICAL BASE-UP  
 POSITION.  
 TOTAL INPUT WATTS = 48.2 AT 240.0 VOLTS  
 LED DRIVER: INTEGRAL LED DRIVER  
 NOTE: DATA SHOWN IS ABSOLUTE FOR THE  
 SAMPLE PROVIDED AT RATED INPUT VOLTAGE  
 (240VAC, 60Hz) TO THE LED DRIVER. THE  
 HI/LOW TOGGLE SWITCH ON THE LED DRIVER  
 WAS PLACED IN THE 350mA (LOW) POSITION  
 FOR THIS TEST.  
 TEST PROCEDURE: IESNA LM-79-08  
 TEST DISTANCE = 25.25 FEET  
 IES Classification: Medium, Type II

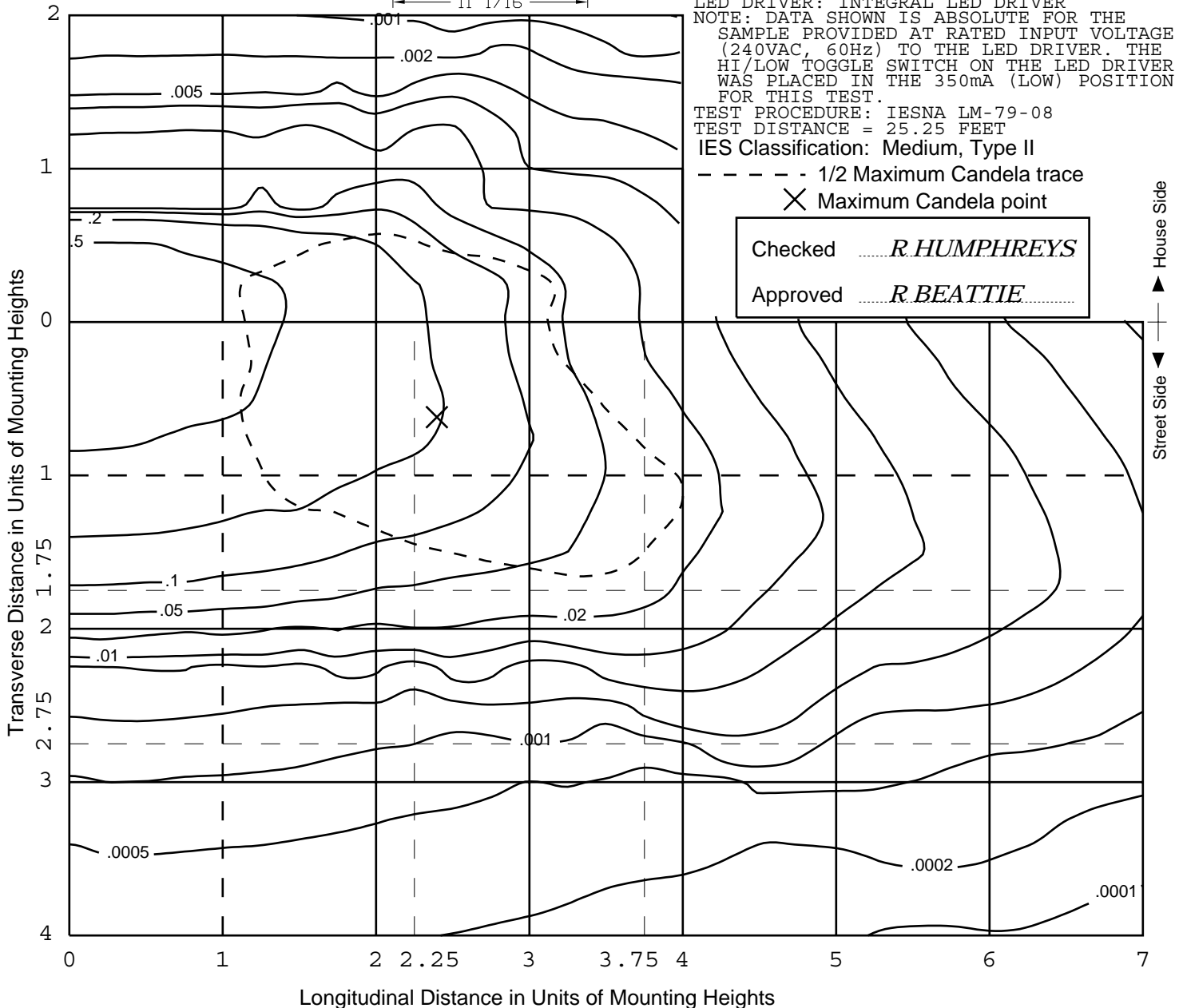

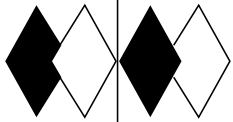

**itl boulder**  
 THE LIGHT CENTER OF THE INDUSTRY SINCE 1955

INDEPENDENT TESTING LABORATORIES, INC.  
 3386 LONGHORN ROAD, BOULDER, CO 80302 USA

PHONE: (303)442-1255 • FAX: (303)449-5274 • E-MAIL: itl@itlboulder.com • WEBSITE: www.itlboulder.com

REPORT NUMBER: ITL65042  
 DATE: 06/08/10  
 PREPARED FOR: ECOFIT LIGHTING  
 CATALOG NUMBER: DURASTREET 42 SERIES,  
 350mA, TYPE 2/3  
 LUMINAIRE: CAST METAL HOUSING. ONE LED  
 MODULE CONSISTING OF: CAST FINNED  
 METAL HEAT SINK AND LED DRIVER  
 HOUSING, ONE WHITE CIRCUIT BOARD WITH  
 SEVEN ROWS OF SIX LEDS, ONE CLEAR  
 PLASTIC LENS BELOW EACH LED, SEVEN  
 MOLDED BLACK PLASTIC REFLECTORS WITH  
 SPECULAR FINISH, CLEAR PLASTIC LENS.  
 CAST GRAY PAINTED METAL DOOR FRAME.  
 LED MODULE NOT DISASSEMBLED FOR  
 INSPECTION.  
 LAMPS: FORTY-TWO WHITE LIGHT EMITTING  
 DIODES (LEDS), VERTICAL BASE-UP  
 POSITION.  
 TOTAL INPUT WATTS = 48.2 AT 240.0  
 VOLTS  
 LED DRIVER: INTEGRAL LED DRIVER  
 NOTE: DATA SHOWN IS ABSOLUTE FOR THE  
 SAMPLE PROVIDED AT RATED INPUT VOLTAGE  
 (240VAC, 60Hz) TO THE LED DRIVER. THE  
 HI/LOW TOGGLE SWITCH ON THE LED DRIVER  
 WAS PLACED IN THE 350mA (LOW) POSITION  
 FOR THIS TEST.  
 TEST PROCEDURE: IESNA LM-79-08  
 TEST DISTANCE = 25.25 FEET

MAXIMUM PLANE AND MAXIMUM CONE PLOTS OF CANDELA

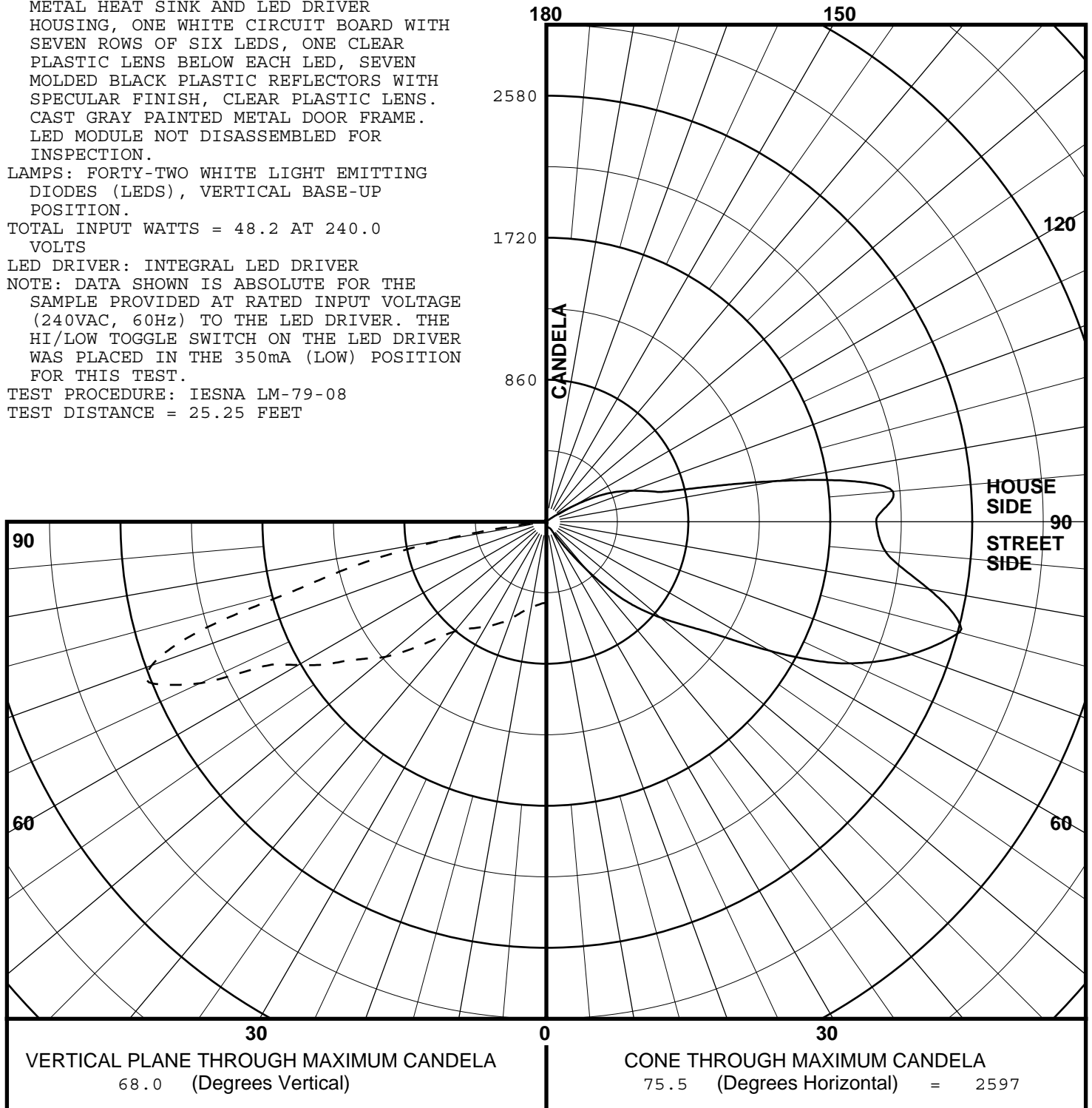



REPORT NUMBER: ITL65042  
 DATE: 06/08/10  
 PREPARED FOR: ECOFIT LIGHTING

COEFFICIENTS OF UTILIZATION AND FLUX DISTRIBUTION

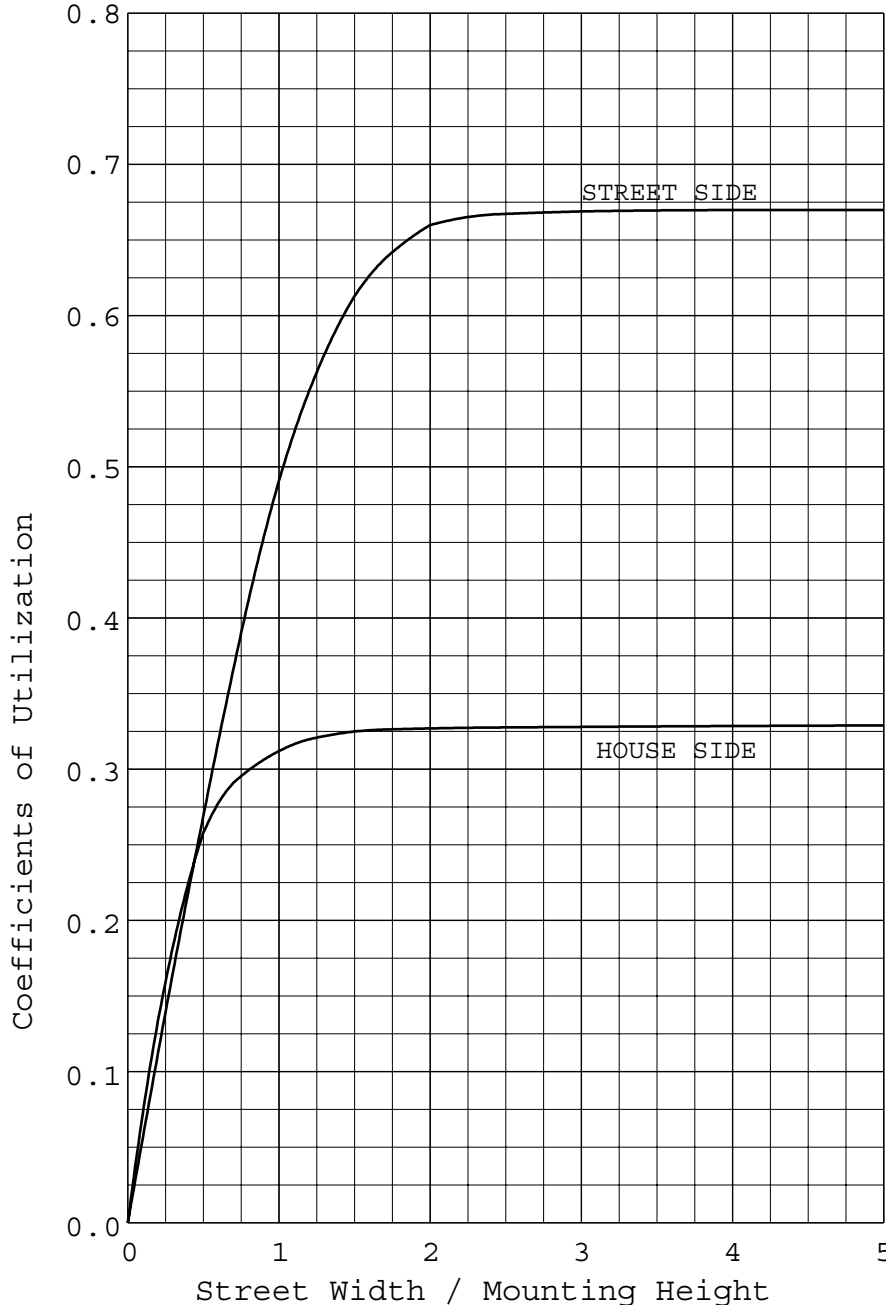

	LUMENS	PERCENT OF FIXTURE
DOWNWARD STREET SIDE	2110.	67.1
DOWNWARD HOUSE SIDE	1034.	32.9
DOWNWARD TOTAL	3144.	100.0
UPWARD STREET SIDE	0.	0.0
UPWARD HOUSE SIDE	0.	0.0
UPWARD TOTAL	0.	0.0
TOTAL FLUX	3144.	100.0
EFFICACY = 65.2 Lm/W		

ALL CANDELA AND LUMENS IN THIS REPORT ARE BASED ON ABSOLUTE PHOTOMETRY. THE COEFFICIENT OF UTILIZATION VALUES ARE BASED ON THE TOTAL ABSOLUTE LUMEN OUTPUT OF THIS LUMINAIRE SAMPLE.



**itl boulder**  
THE LIGHT CENTER OF THE INDUSTRY SINCE 1955

INDEPENDENT TESTING LABORATORIES, INC.  
 3386 LONGHORN ROAD, BOULDER, CO 80302 USA

PHONE: (303)442-1255 • FAX: (303)449-5274 • E-MAIL: itl@itlboulder.com • WEBSITE: www.itlboulder.com

REPORT NUMBER: ITL65042  
 DATE: 06/08/10  
 PREPARED FOR: ECOFIT LIGHTING

FLUX DISTRIBUTION BY SOLID ANGLE

(PER IESNA TM-15-07, LUMINAIRE CLASSIFICATION SYSTEM FOR OUTDOOR LUMINAIRES)

	LUMENS	PERCENT OF FIXTURE	BUG ZONE RATINGS
FORWARD LIGHT	2110.	67.1	
FL ( 0- 30)	247.2	7.9	
FM ( 30- 60)	1075.2	34.2	
FH ( 60- 80)	770.0	24.5	G1
FVH( 80- 90)	17.4	0.6	U1 G1
BACK LIGHT	1034.	32.9	
BL ( 0- 30)	237.3	7.5	B1
BM ( 30- 60)	519.1	16.5	B1
BH ( 60- 80)	272.9	8.7	B1 G1
BVH( 80- 90)	5.1	0.2	U0 G0
UPLIGHT	0.	0.0	
UL ( 90-100)	0.0	0.0	U0
UH (100-180)	0.0	0.0	U0
TRAPPED LIGHT	0.	0.0	
TOTAL FLUX	3144.	100.0	

BACKLIGHT, UPLIGHT, AND GLARE (BUG) RATINGS  
 (PER ADDENDUM A FOR IESNA TM-15-07)

BUG RATING: B1 U1 G1

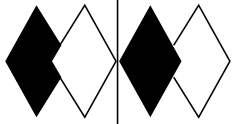

# itl boulder

THE LIGHT CENTER OF THE INDUSTRY SINCE 1955

INDEPENDENT TESTING LABORATORIES, INC.  
3386 LONGHORN ROAD, BOULDER, CO 80302 USA

PHONE: (303)442-1255 • FAX: (303)449-5274 • E-MAIL: itl@itlboulder.com • WEBSITE: www.itlboulder.com

REPORT NUMBER: ITL65042  
PREPARED FOR: ECOFIT LIGHTING

DATE: 06/08/10

## CANDELA TABULATION

	STREET SIDE												
	0.0	5.0	15.0	25.0	35.0	45.0	55.0	65.0	75.0	75.5	85.0		
	90.0	0.	0.	0.	0.	0.	0.	0.	0.	0.	0.	0.	0.
	87.5	1.	1.	1.	2.	3.	4.	5.	8.	14.	14.	12.	
	85.0	3.	3.	3.	4.	5.	7.	10.	19.	42.	46.	40.	
	82.5	4.	4.	4.	6.	8.	11.	16.	40.	187.	214.	118.	
	80.0	5.	6.	6.	8.	11.	15.	25.	154.	671.	642.	285.	
	77.5	8.	9.	10.	12.	16.	22.	46.	883.	1183.	1113.	544.	
	75.0	11.	13.	14.	17.	22.	33.	147.	1529.	1577.	1523.	785.	
	72.5	16.	18.	19.	24.	31.	60.	702.	1821.	2209.	2206.	1370.	
	70.0	22.	24.	26.	32.	48.	324.	1088.	1935.	2533.	2545.	1943.	
	68.0 <<	28.	29.	34.	44.	127.	674.	1141.	2030.	2591.	2597.	2062.	
	67.5	31.	33.	38.	52.	204.	755.	1256.	2003.	2562.	2567.	2094.	
	65.0	53.	55.	83.	232.	591.	960.	1317.	1783.	2317.	2315.	2078.	
	62.5	243.	258.	357.	554.	742.	1003.	1501.	1685.	1914.	1873.	1820.	
	60.0	486.	492.	547.	669.	818.	1000.	1541.	1756.	1813.	1735.	1640.	
V	57.5	574.	581.	629.	735.	832.	1027.	1391.	1610.	1635.	1612.	1731.	
E	55.0	637.	640.	664.	737.	847.	1089.	1245.	1513.	1460.	1465.	1589.	
R	52.5	642.	640.	661.	749.	885.	1095.	1198.	1419.	1350.	1360.	1470.	
T	50.0	659.	659.	693.	787.	928.	969.	1148.	1323.	1261.	1272.	1337.	
I	47.5	701.	700.	730.	811.	885.	909.	1106.	1146.	1145.	1160.	1230.	
C	45.0	733.	734.	772.	815.	802.	903.	1016.	1013.	1041.	1046.	1108.	
A	42.5	749.	746.	727.	729.	798.	888.	949.	865.	932.	943.	1021.	
L	40.0	668.	667.	676.	728.	805.	862.	868.	800.	862.	869.	910.	
	37.5	666.	668.	688.	740.	797.	829.	781.	758.	815.	819.	853.	
A	35.0	681.	683.	700.	736.	774.	784.	715.	728.	784.	788.	807.	
N	32.5	682.	683.	695.	717.	746.	713.	678.	707.	756.	759.	776.	
G	30.0	670.	671.	678.	693.	689.	652.	655.	691.	733.	734.	742.	
L	27.5	650.	650.	651.	640.	622.	617.	639.	677.	706.	707.	711.	
E	25.0	598.	598.	590.	579.	579.	598.	626.	660.	679.	679.	678.	
	22.5	543.	545.	544.	546.	559.	582.	611.	639.	653.	653.	652.	
	20.0	522.	524.	527.	534.	547.	567.	593.	616.	624.	623.	622.	
	17.5	517.	519.	521.	527.	537.	554.	575.	589.	593.	593.	592.	
	15.0	514.	515.	516.	522.	532.	543.	557.	564.	565.	565.	566.	
	12.5	513.	514.	515.	518.	526.	532.	539.	541.	541.	542.	543.	
	10.0	509.	510.	511.	515.	518.	521.	524.	526.	524.	524.	524.	
	7.5	505.	506.	507.	509.	510.	511.	512.	513.	513.	513.	512.	
	5.0	499.	499.	500.	500.	498.	500.	502.	502.	503.	503.	503.	
	2.5	490.	491.	492.	493.	493.	493.	493.	494.	494.	494.	495.	
	0.0	490.	490.	490.	490.	490.	490.	490.	490.	490.	490.	490.	

PLANE OF MAXIMUM CANDELA

CONE OF MAXIMUM CANDELA

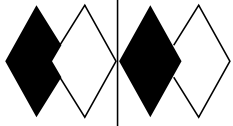

# itl boulder

THE LIGHT CENTER OF THE INDUSTRY SINCE 1955

INDEPENDENT TESTING LABORATORIES, INC.  
3386 LONGHORN ROAD, BOULDER, CO 80302 USA

PHONE: (303)442-1255 • FAX: (303)449-5274 • E-MAIL: itl@itlboulder.com • WEBSITE: www.itlboulder.com

REPORT NUMBER: ITL65042  
PREPARED FOR: ECOFIT LIGHTING

DATE: 06/08/10

## CANDELA TABULATION

	HOUSE SIDE	LATERAL ANGLE										
		90.0	95.0	105.0	115.0	125.0	135.0	145.0	155.0	165.0	175.0	180.0
	90.0	0.	0.	0.	0.	0.	0.	0.	0.	0.	0.	0.
	87.5	9.	8.	6.	3.	2.	1.	1.	0.	0.	0.	0.
	85.0	29.	24.	14.	7.	4.	3.	2.	1.	1.	1.	1.
	82.5	73.	57.	28.	12.	7.	4.	3.	3.	2.	2.	2.
	80.0	177.	167.	55.	18.	9.	6.	4.	3.	2.	2.	2.
	77.5	419.	416.	186.	29.	13.	8.	6.	4.	3.	3.	3.
	75.0	687.	692.	328.	60.	17.	10.	7.	5.	4.	4.	3.
	72.5	1226.	1276.	250.	181.	23.	12.	8.	6.	5.	4.	4.
	70.0	1813.	1900.	357.	448.	36.	15.	10.	7.	6.	5.	4.
	68.0<<	1998.	2107.	698.	400.	54.	18.	11.	8.	7.	6.	5.
	67.5	2046.	2108.	950.	339.	70.	20.	11.	9.	7.	6.	6.
	65.0	2039.	2011.	1471.	191.	172.	29.	14.	10.	8.	7.	7.
	62.5	1845.	1817.	1498.	146.	252.	51.	19.	12.	9.	8.	8.
	60.0	1670.	1652.	1618.	127.	172.	102.	28.	15.	11.	10.	9.
V	57.5	1749.	1736.	1693.	202.	120.	143.	60.	22.	15.	12.	11.
E	55.0	1605.	1603.	1602.	515.	96.	109.	97.	46.	24.	17.	17.
R	52.5	1482.	1483.	1467.	859.	81.	78.	116.	74.	49.	38.	37.
T	50.0	1355.	1359.	1336.	976.	81.	67.	83.	95.	71.	59.	58.
I	47.5	1247.	1258.	1220.	956.	180.	60.	69.	71.	79.	77.	76.
C	45.0	1124.	1132.	1125.	919.	442.	55.	59.	57.	58.	61.	61.
A	42.5	1042.	1045.	1001.	886.	676.	79.	54.	51.	49.	48.	48.
L	40.0	922.	926.	886.	849.	697.	240.	50.	48.	46.	44.	44.
	37.5	861.	868.	825.	808.	679.	518.	94.	45.	42.	40.	41.
A	35.0	814.	819.	780.	765.	684.	618.	301.	70.	41.	39.	39.
N	32.5	775.	778.	748.	733.	702.	600.	530.	247.	101.	60.	57.
G	30.0	742.	742.	722.	711.	681.	608.	547.	488.	337.	232.	223.
L	27.5	710.	711.	697.	676.	657.	615.	549.	510.	502.	468.	464.
E	25.0	678.	681.	672.	648.	638.	607.	566.	521.	492.	480.	479.
	22.5	651.	652.	648.	627.	616.	590.	569.	544.	517.	501.	501.
	20.0	622.	623.	622.	605.	584.	580.	556.	544.	533.	523.	525.
	17.5	593.	594.	594.	583.	567.	554.	553.	536.	527.	524.	524.
	15.0	567.	568.	567.	563.	551.	536.	531.	530.	529.	526.	526.
	12.5	544.	545.	545.	545.	538.	528.	519.	512.	511.	512.	511.
	10.0	525.	526.	527.	528.	525.	520.	517.	510.	506.	503.	502.
	7.5	512.	512.	514.	516.	516.	514.	512.	508.	506.	505.	505.
	5.0	503.	502.	503.	503.	504.	503.	503.	502.	501.	501.	500.
	2.5	494.	494.	494.	494.	494.	494.	493.	493.	493.	493.	494.
	0.0	490.	490.	490.	490.	490.	490.	490.	490.	490.	490.	490.

CONE OF MAXIMUM CANDELA